

## Lumistar Luminaire USL 06LED Ex Sight glass luminaire in Ex

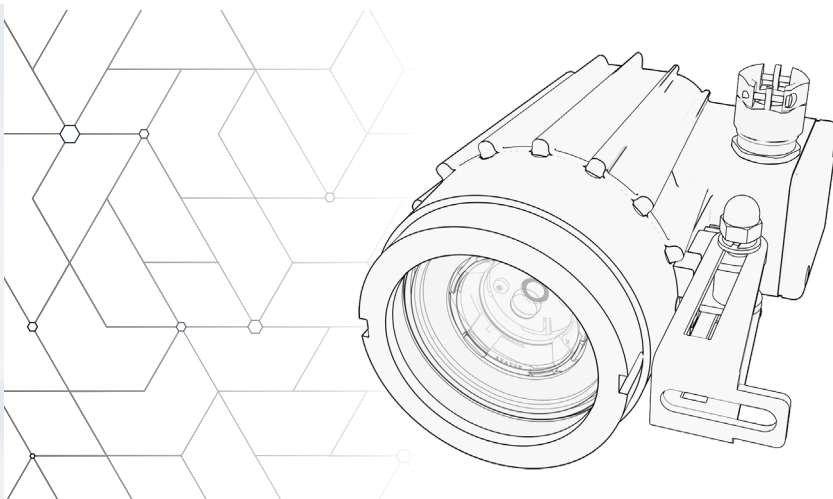

### APPLICATION:

For safe use in potentially explosive environments in zones 1, 2, 21 and 22 (gas and dust).

This Lumistar variant impresses with its versatility:

- as a vehicle luminaire
- for the optimal illumination of closed vessels, boilers, tanks, silos, agitators and reactors.
- in combination with flow sight glasses

For use with circular sight glass fittings to DIN 28120/DIN 28121 or similar, with screw-type sight glass fittings in compliance with DIN 11851, and in visual flow indicators.

Trend-setting LED technology guarantees even lower energy consumption, longer service life and flexible light colour.

### PROTECTION:

IP 65 and IP 67 to DIN EN 60529

### AMBIENT TEMPERATURES:

-20°C to 50°C

### TECHNICAL DATA EX PROTECTION:

Approval according to Directive 2014/34/EU

This luminaire meets the essential safety and health requirements by complying with the regulations for:

Gas	
EN IEC 60079-0:2018	General Requirements
EN 60079-1:2014	Flame-proof Enclosures „d“
EN IEC 60079-7:2015 + A1:2018	Increased Safety „e“
Explosion group	IIC (includes IIA and IIB)
Temperature class	T6

Dust	
EN IEC 60079-0:2018	General Requirements
EN 60079-31:2014	Protection by Enclosures „t“
Explosion group	IIIC (includes IIIA and IIIB)
Temperature class	T80°

EU-Type Examination Certificate:  
BVS 08 ATEX E 135

II 2G Ex db eb IIC T6 Gb  
 II 2D Ex tb IIIC T80°C Db

Voltage	Nominal power	Nominal luminous flux	Light colour*	Beam angle	Addition	Part no.
12 V/24 V DC	9 W	450-500 lm	6500 K cold white	12°		3542.230.00
12 V/24 V DC	9 W	450-500 lm	6500 K cold white	25°		3542.231.00
12 V/24 V DC	9 W	450-500 lm	6500 K cold white	38°		3542.232.00
12 V/24 V DC	9 W	450-500 lm	6500 K cold white	12°	including sealing plug	3542.233.00
24 V AC/DC	14 W	450-500 lm	6500 K cold white	12°		3542.235.00
24 V AC/DC	14 W	450-500 lm	6500 K cold white	25°		3542.236.00
24 V AC/DC	14 W	450-500 lm	6500 K cold white	38°		3542.237.00
220-240 V AC	7 W	depending on the lamp type			socket GU10	3542.245.00

\*other light colours on request

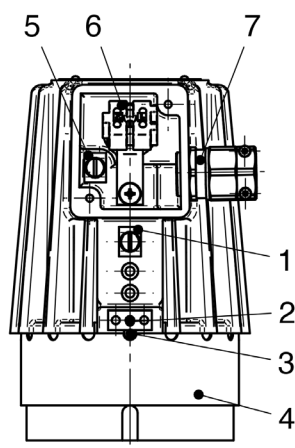

- 1 Protective conductor terminal outside
- 2 Locking screw
- 3 Locking lug
- 4 Screw glass
- 5 Internal protective conductor terminal
- 6 Ex terminals
- 7 Cable gland M20 x 1.5

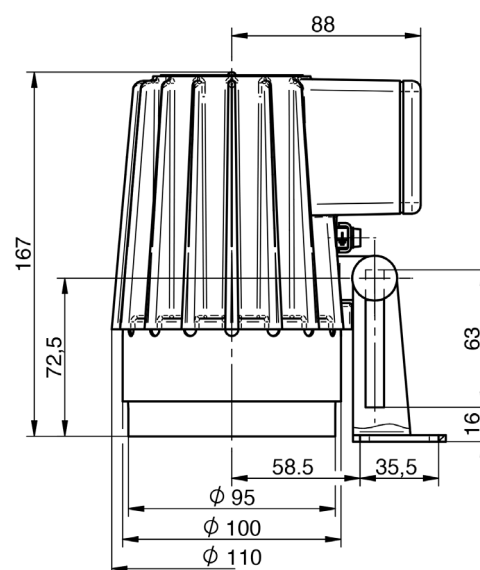

#### FIXING:

In the case of a round sightglass fitting and a visual flow indicators, the luminaire is fixed to the cover flange with the mounting bracket. With a screw-in sightglass fitting, the luminaire is fixed on the slotted cover nut, alternatively via a flanged adapter collar or a mounting bracket.

#### ELECTRICAL CONNECTION:

Cable entry variable (right or left).  
The unused opening is closed with a sealing plug. Cable lengths: any Cable diameter: 8-15 mm

#### NOMINAL WIDTHS:

For round sightglasses similar to DIN 28120, DIN 28121 and flow sightglasses, fixing on cover flange: from DN 50.

For screwed sightglasses similar to DIN 11851, fixing on or under the slotted cover nut:  
DN 65, 80, 100: via flanged adapter collar  
DN 80, 100, 125: via mounting bracket  
DN 80, 100: via flanged adapter collar or mounting bracket

#### WEIGHT:

2.1 kg including connection box

#### Materials

Luminaire body	Aluminium
Glass	Borosilicate
Mounting parts	Stainless steel
Flat gasket terminal box	Viton

#### Additional equipment

Additional equipment	Part no.
Luminaire fixing mounting bracket, stainless steel	0354.016.00
Luminaire fixing flanged adapter collar, stainless steel	1356.015.00
LED lens 12°	3511.008.00
LED lens 25°	3511.009.00
LED lens 38°	3511.010.00
Assembly spanner for screwed sight glass	6805.001.00

Order specifications (example):

Part no. 3542.232.00: Lumistar luminaire USL 06LED Ex, 12 V/24 V DC, 9 W, beam angle 38°

Part no. 1356.015.00: Luminaire flanged adapter collar