

ESL25Ex Sanitary Stainless Steel ATEX Approved Light & Metaclamp[®]

Type 80.ESL25Ex

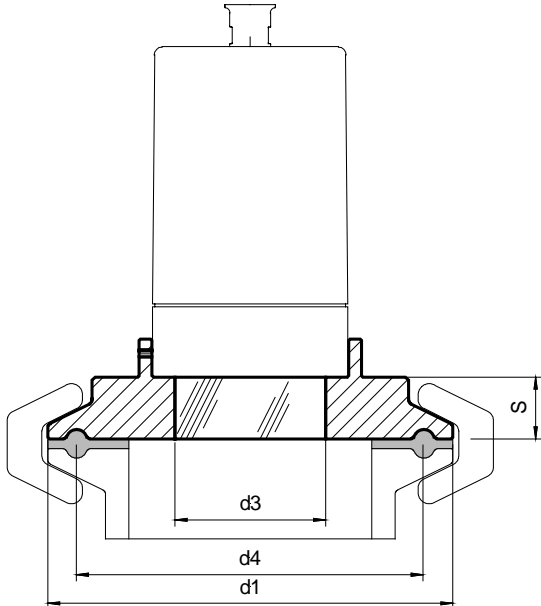

For

- Tri-Clamp to DIN 32 676 / ISO 2852
Also available for NA-Connect – contact Visilume.

Advantages:

- Optimum design for pharmaceutical & biotech applications
- Minimal crevices for sanitary applications
- Suitable for food processing (3-A Standard)
- Dust & Water jet resistant (IP65) even during external wash down
- Simple & fast installation with no risk of breakage
- Sightglass resistant to catastrophic failure
- Very high resistance to impact
- ATEX Approved

Operating Pressure: -1 to 16 bar

Operating Temperature: see table below

Ring Material	Operating Temperature
Duplex Stainless Steel (1.4462)	-30°C to +280°C
Hastelloy C-22 (2.4602)	-60°C to +300°C
Hastelloy C-4 (2.4610)	-60°C to +300°C

Standar Tube OD		d1	d3	d4	S	Maximum pressure [bar]
DN (mm)	DN (inch)					
65	3"	91	40	83,5	10	10
80	3½"	106	50	97	10	10
100	4"	119	55	110	12	10
	6"	167	70	156,5	16	6

Technical Data:

Metaclamp Manufactured and Tested to:

- Directive for pressure equipment 97/23/EG 02/98 Module H/H1 (DIN/EN/ISO 9001)
- AD Standards W0/TRD 100
- Sight glass fused to metal conforming to DIN 7079
- Materials to Vd TÜV specifications and the DIN/EN designated standard
- Glass: Borosilicate to DIN 7080

Material Certificate:

Certificate of conformity to EN 10204-3.1B (or 3.1A at extra cost)

ESL25-Ex Light Fitting

- ATEX Approved: Ex II 2G EEx d II C T4 / T5 / T6 IIC (all Explosion classes)
- Supply 12, 24, 120 or 230V AC/DC
- Power: 5, 10 or 20 W
- Maximum temperature: 60°C (100°C possible with alternate cable gland)